

Changes to Manningham Road

Construction Update
December 2025



Construction works at the Manningham Road interchange, Bulleen

As works on the future Manningham Road interchange power ahead, eastbound traffic is being moved back to Manningham Road.

To safely move traffic onto the new lanes, there will be temporary changes to traffic conditions throughout January. This will create the space needed to build the interchange entry and exit ramps that take 14,700 vehicles off Bulleen Road each day when North East Link opens in 2028.

From mid-January, there will be intersection, road and lane closures on Manningham Road, Bulleen Road and Bridge Street, with traffic management and detours in place to safely move traffic through the area.

To allow crews to continue building the tunnel entry ramp, eastbound traffic will be moved back onto Manningham Road, with local access only on Bridge Street.

Drivers should plan ahead to avoid delays while we deliver these works.

Delays of up to 60 minutes are expected at times.

We'll continue to keep you updated on traffic changes via on road signage and you can find the latest information via bigbuild.vic.gov.au/disruptions

Key information

- 13-22 January:**
Restricted movements overnight at the Manningham Road/ Bulleen Road intersection.
- 14-18 January**
Reduced lanes on Manningham Road, Bulleen Road and Bridge Street.

Bulleen Road closed between Bridge Street and Manningham Road.
- 18-19 January:**
Manningham Road/ Bulleen Road intersection closed overnight.
- 19-24 January**
Eastbound traffic moved onto Manningham Road with reduced lanes.

Bridge Street local access maintained via Templestowe Road.
- 24 January onwards**
New Manningham Road lanes open.



Sign up for updates
northeastlink.vic.gov.au



Upcoming traffic disruptions

From 6am Wednesday 14 January to 7pm Sunday 18 January, there will be intersection and lane closures on Manningham Road and Bridge Street to allow crews to safely complete works. Bulleen Road northbound between Manningham Road and Bridge Street will also be closed during this time with reduced lanes travelling southbound.

Detours will be in place via Lower Heidelberg and Thompsons roads, with local access maintained for nearby residents and businesses.

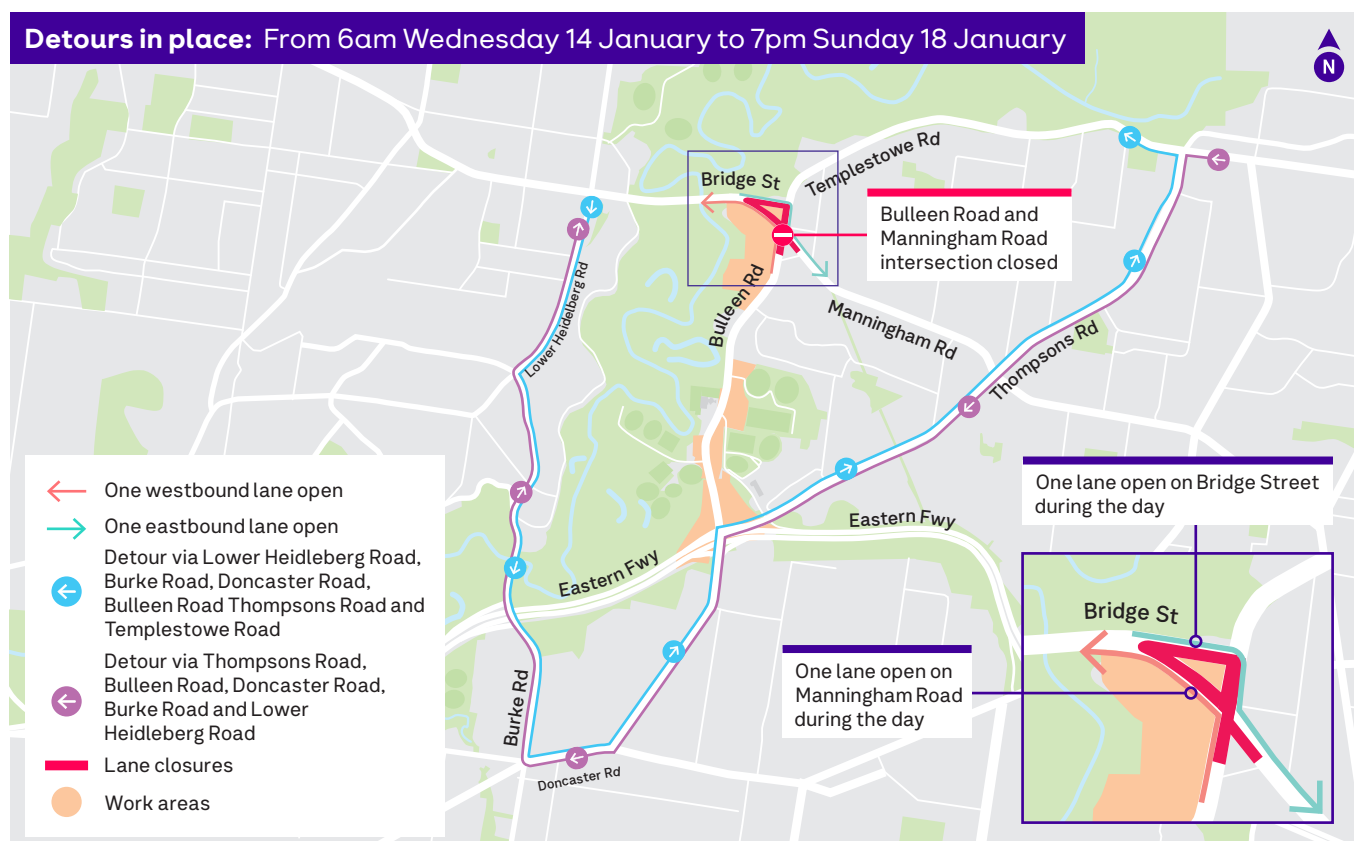
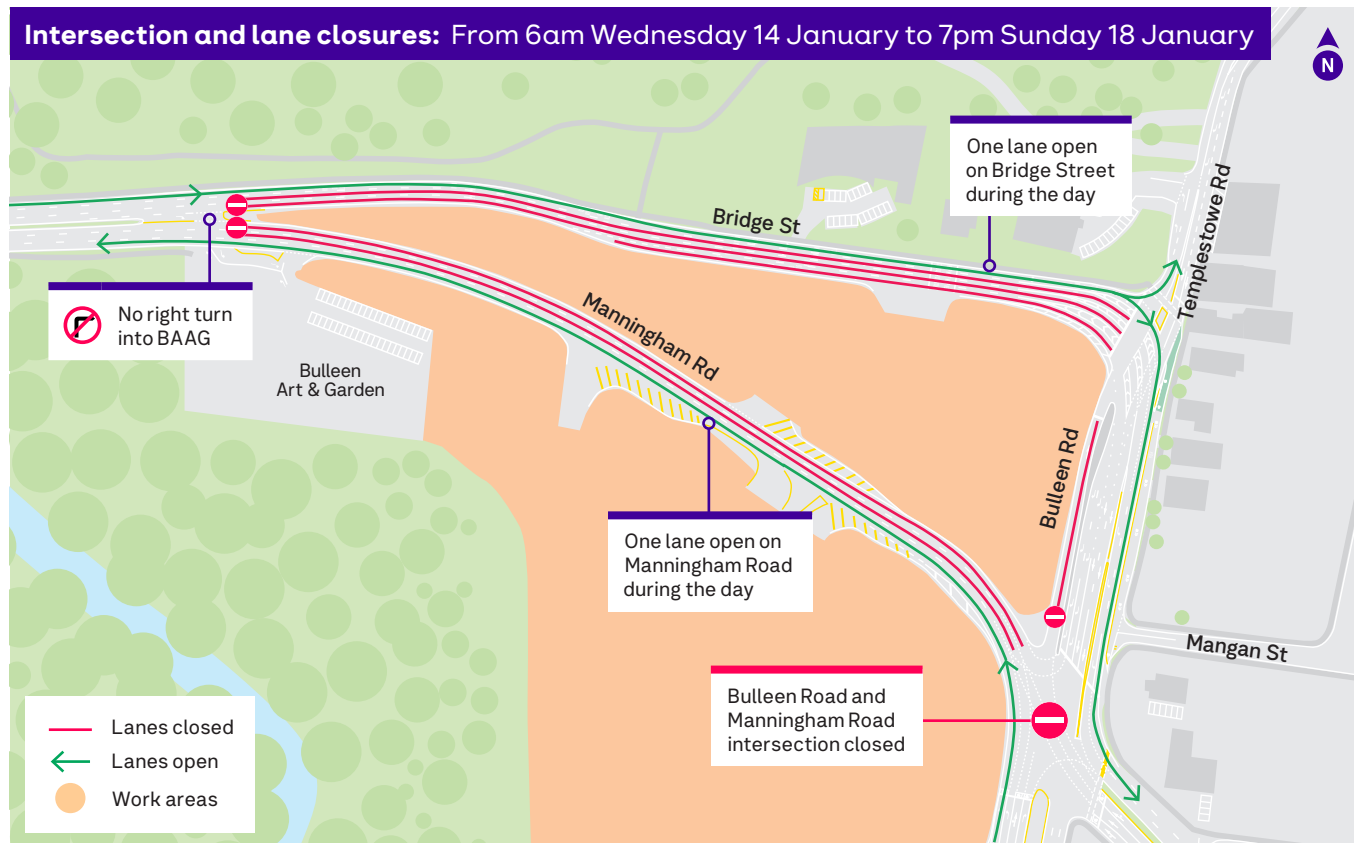

New Manningham Road lanes

From 6am Monday 19 January, eastbound traffic will be moved back onto Manningham Road. Bridge Street access will be maintained via Templestowe Road.

This change will be in place until the final Bridge Street lanes are built later in the project.

Lane closures will be in place in both directions on Manningham Road **between 19 to 24 January**.

From 24 January, the new Manningham Road lanes will be open, with reduced lanes in place at times until February.

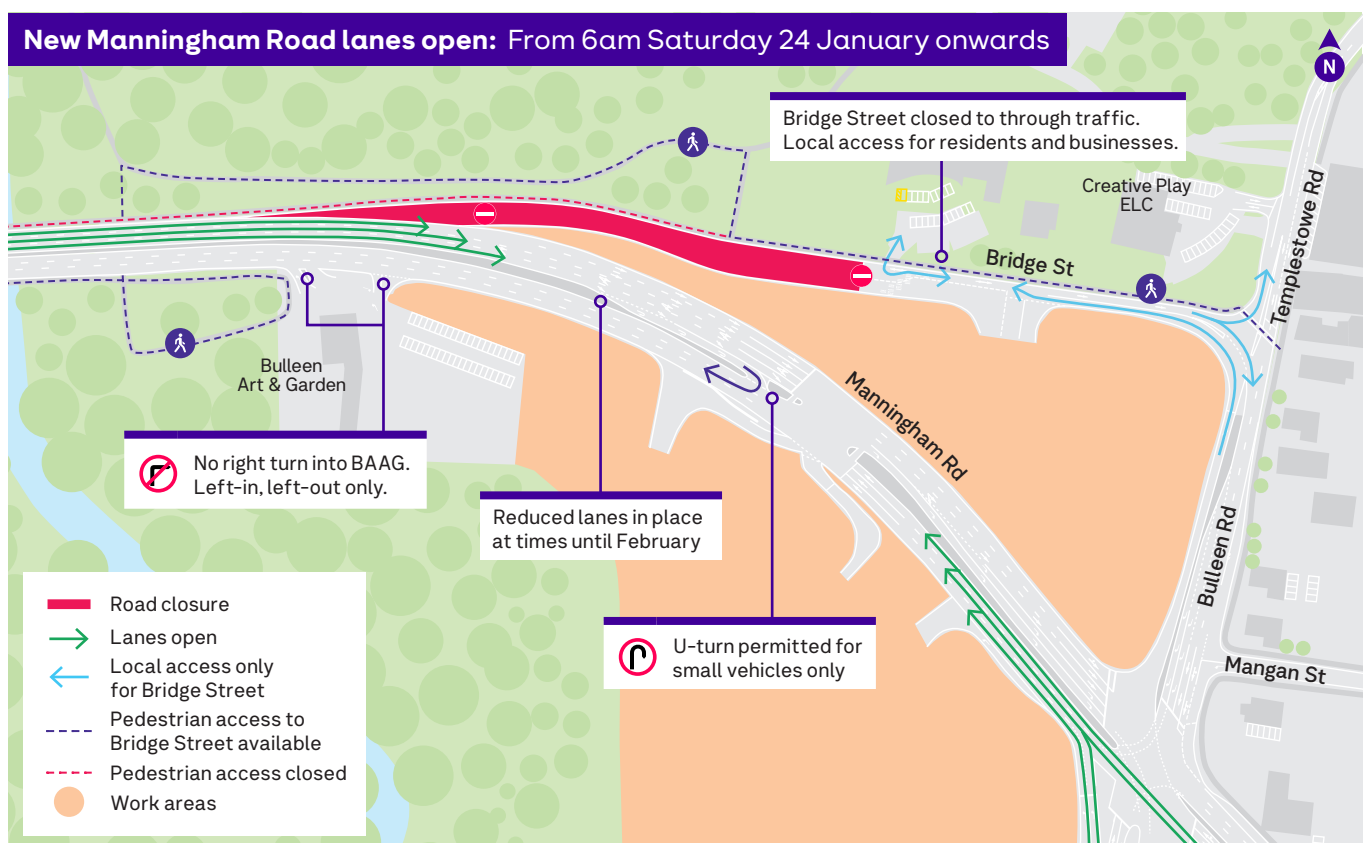
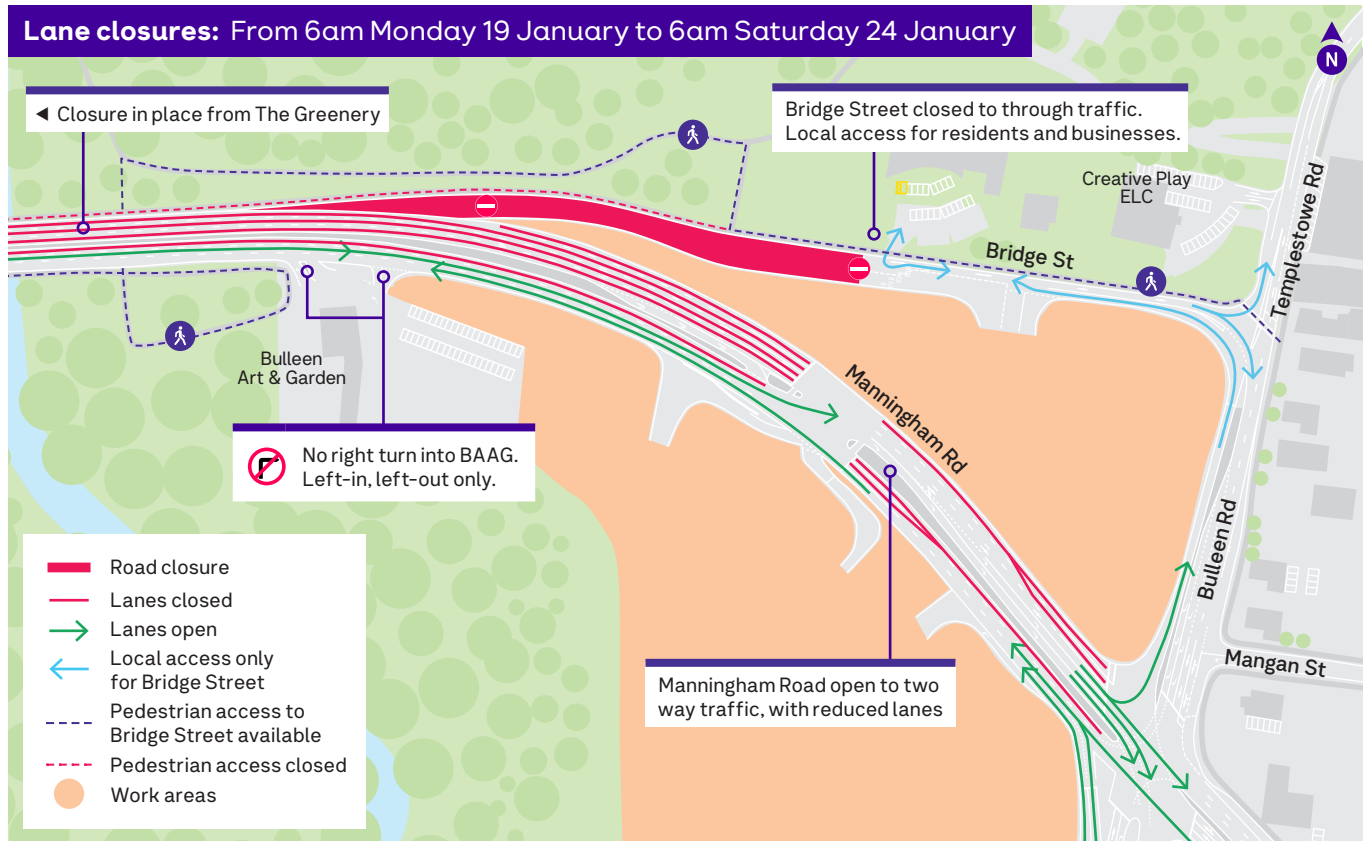

Overnight closures from 7pm to 6am

The intersections of Manningham and Bulleen Road and Bridge Street will have lane closures each night from 13 to 22 January and a full intersection closure from 18 to 19 January.

During these overnight works, detours will be in place via Lower Heidelberg and Thompsons road with local access maintained.

Restricted movements at night: 7pm to 6am, Tuesday 13 January to Thursday 22 January

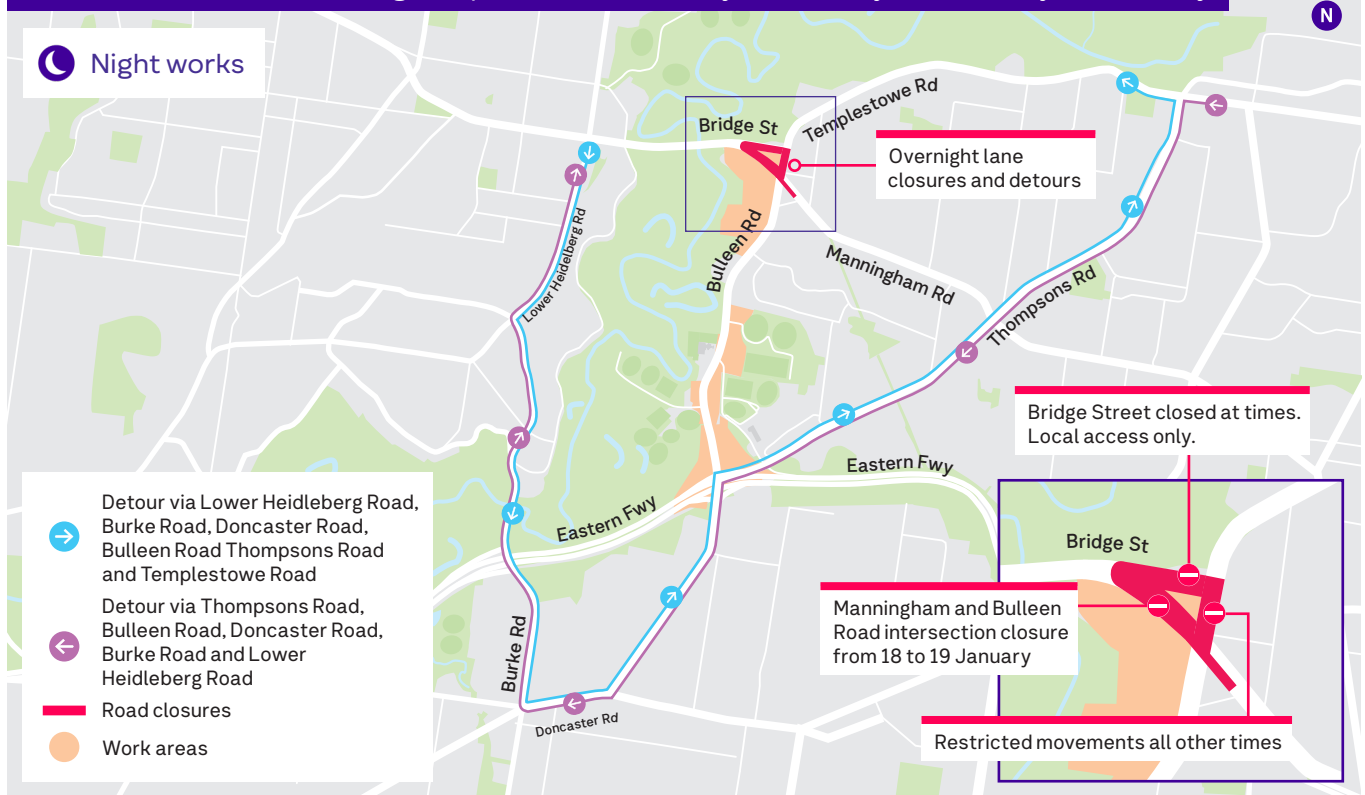

Eastern Freeway and M80 disruptions

The Eastern Freeway will be closed in both directions between Doncaster Road and Middleborough Road from 10pm, Wednesday 7 January to 5am, Monday 12 January. Significant delays of up to 90 minutes are expected. Doncaster Road citybound exit ramp also closed from 10pm, Wednesday 7 January to 5am, Friday 23 January.

Work is continuing behind barriers on M80 Ring Road and Greensborough Bypass to build the new M80 interchange and ramps. In early 2026, sections of Greensborough Highway will be closed to install the new Nell Street pedestrian and cycling bridge.

Please plan your trip and allow additional travel time.



Scan the QR code for further information on these disruptions.

northeastlink.vic.gov.au

1800 105 105 (call anytime)

community@northeastlink.vic.gov.au



For languages other than English please call 9209 0147

 @nelpvic

Please contact us if you would like this information in an accessible format. If you need assistance due to a hearing or speech impairment, visit relayservice.gov.au



Australian Government
BUILDING AUSTRALIA

